

# OVEN FRESH

CONTINUOUS HEAT FOOD DELIVERY SYSTEMS



Designed and Assembled in the USA

# THE ELECTRIC HOTBAG®

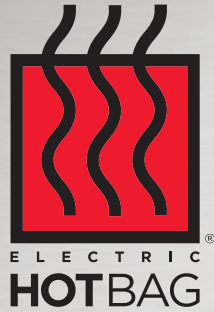

In 1993 we introduced The ELECTRIC HOTBAG®, the world's first electrically heated food delivery bag. Today our family of products and patented technology are sold worldwide and are the key ingredient for oven fresh food delivery across every food service category.



## One plug. Any bag.

All ELECTRIC HOTBAGS® share the same universal power connections. (Excludes the battery powered HB-FS4)

## High Quality Materials

Check Corporation uses only the highest quality materials for the fabrication of each bag, making them the most durable and reliable delivery solution in the industry.

## Quick Connect Power

The quick connect power cords allow you to easily connect/disconnect from your power supplies or power source. Fast, easy, efficient.

## Moisture Management

The ELECTRIC HOTBAG® uses only the finest insulation, which helps maintain proper food temperatures while wicking away moisture and condensation.

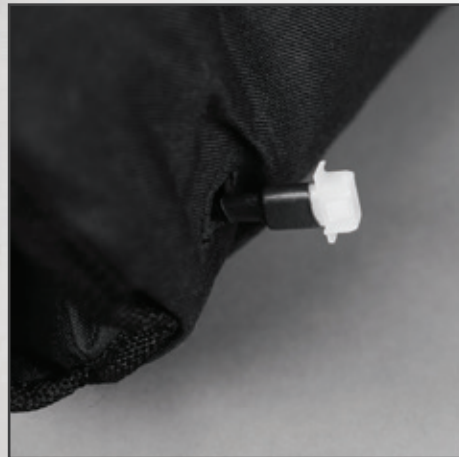

All HOTBAG® models are also available as insulated-only (non-heated) bags.

# DELIVERY | Pizza • Quick Service • Casual Dining • Fine Dining

You use the best ingredients and work hard to provide customers with the highest quality foods. Let us help you deliver the freshest food possible!

## HB-1

18"W x 19"L x 6"H

### SMALL SIZE BAG

#### FRONT LOADING

Holds equivalent of (2) 16" or (3) 14" pizza boxes.

#### Item To Order

- HB-1

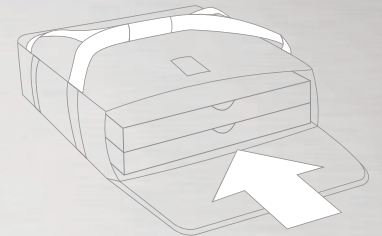

## HB-XW

19.5"W x 20"L x 8"H

### MEDIUM SIZE BAG

#### FRONT LOADING

Holds equivalent of (3) 18" or (4) 16" pizza boxes.

#### Item To Order

- HB-XW

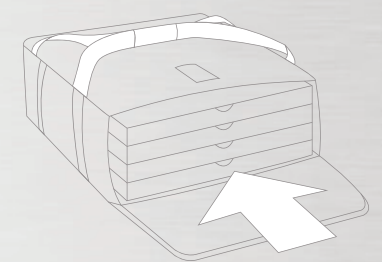

## HB-2

18"W x 21"L x 13"H

### LARGE SIZE BAG

#### FRONT LOADING

Holds equivalent of (6) 16" or (7) 14" pizza boxes.

#### Item To Order

- HB-2

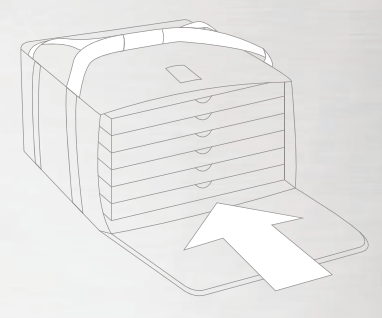

## HB-FS-3

16"W x 10"L x 12"H

### PASTA & SANDWICH BAG

#### TOP LOADING

Designed to fit multiple sized containers.

#### Item To Order

- HB-FS-3



**Mobile. Modular. Lightweight.**

Our premium line of electrically heated catering bags provide all the benefits of commercial catering systems for only a fraction of the cost. No dollies, no large trucks, just pack, pick up and go.

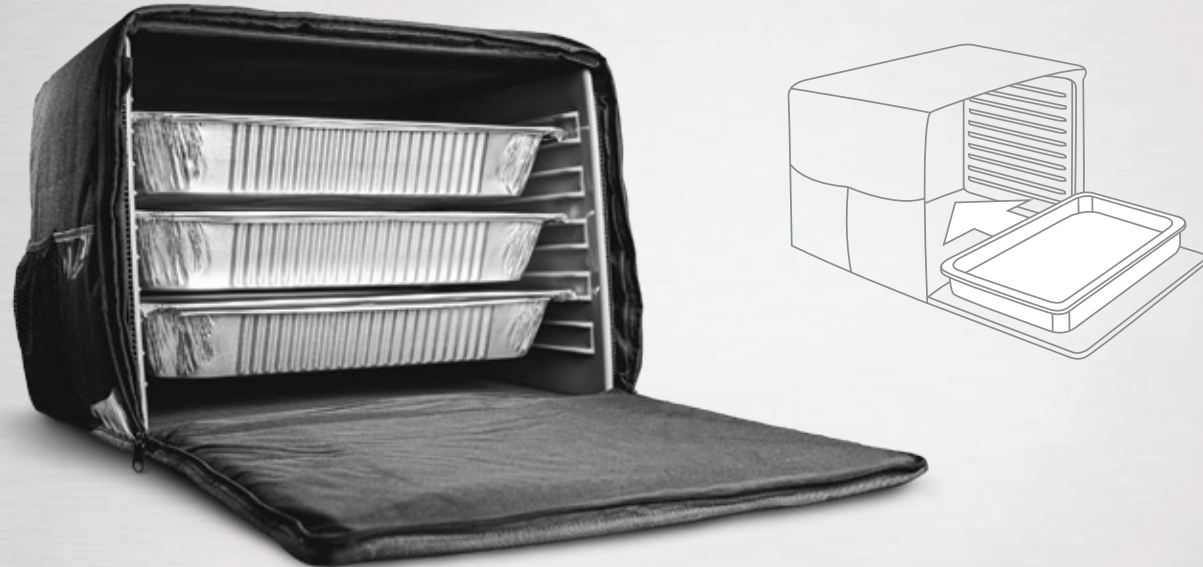

**HB-CATER**

22"W x 16"L x 16"H

**FRONT LOADING**

Built-in slots hold up to (5) full-size hotel/catering pans.

- Folds flat for easy storage
- Liquid resistant
- 2 Heating Elements

Items To Order

- HB-CATER (Includes internal side panels)
- HB-CATER-NSP (Does NOT include internal side panels)

**HB-CATER3**

22"W x 16"L x 16"H

**FRONT LOADING**

Built-in slots hold up to (5) full-size hotel/catering pans.

- 3 Heating Elements
- Heats up quicker and to a higher temperature than HB-CATER

Items To Order

- HB-CATER3 (Includes internal side panels)
- HB-CATER3-NSP (Does NOT include internal side panels)

**POWER SUPPLIES**

Power supply KIT's include all cords needed from wall to power unit and from power unit to bag.

**6 WAY DISTRIBUTION UNIT**

- Six position AC power supply
- 110-240v • 50-60h

Items To Order

10 FT. CORDS (Power unit to bag)

- HBPS-6-10FT-KIT-NA
- HBPS-6-10FT-KIT-EUR
- HBPS-6-10FT-KIT-UK
- HBPS-6-10FT-KIT-AUS



Input cord options by region.



**SINGLE**

- Single position AC power supply
- 110-240VAC
- 50-60hz



Items To Order

- HBPS-1-KIT-NA
- HBPS-1-KIT-EUR
- HBPS-1-KIT-UK
- HBPS-1-KIT-AUS

**ACCESSORIES**

**SCOOTER POWER SUPPLY**

- Scooter power supply adaptor
- Powers two bags at one time

Item To Order

- SPA-1



**LIGHTER PLUG**

- 12vDC lighter plug power cord

Item To Order

- HBPC-AMP-72



**LIGHTER PLUG ADAPTOR**

- Multi-plug adaptor
- (3) Lighter plugs

Item To Order

- A13-97



**CATERING SIDE PANELS**

- Fits HB-Cater

Item To Order

- HB-CATER-SP



**CATERING SHELF**

- Fits HB-Cater, HB-Cater-3

Item To Order

- HB-CATER-SHELF



**HEATING ELEMENTS**

- Replaceable heating elements

Item To Order

- HB-BTMR-LS

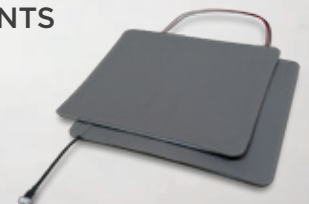

## CONTINUOUS HEAT

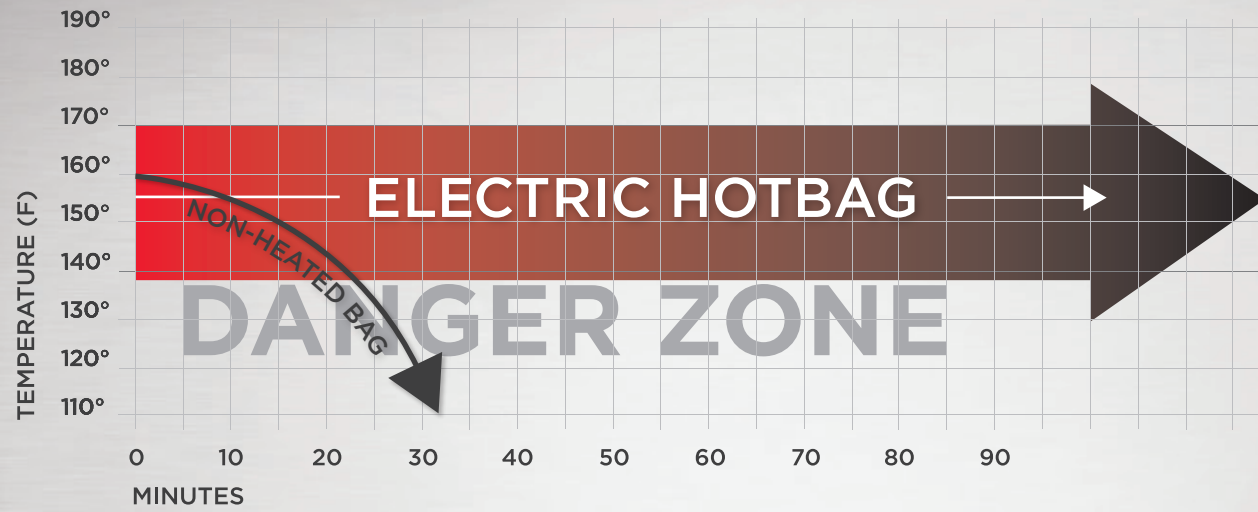

## Orders, Quotes & Questions

Contact us today!

**+1 (248) 680-2323**

8am-5pm EST, Mon-Fri

orders@checkcorp.com



hotbag.com

## SYSTEM VALUE COMPARISON



### SYSTEM TYPE

SYSTEM DESCRIPTION	ELECTRIC HOTBAG (DC System)	Magnetic Induction	AC System	Alternative DC System
VOLTAGE	12v electrical consumption	110-240v AC (product specific)	110v only	12v electrical consumption
ENERGY EFFICIENCY	50-70 watts/bag	600-1800 watts/bag	200 watts/bag	34-81 watts/bag
HEATING ELEMENTS	Flexible heating elements	Rigid heating element (bottom only)	Rigid heating element (bottom only)	Rigid heating elements (top & bottom)
LIGHT WEIGHT	Yes	No	Yes	Yes
BATTERY POWER OPTION	Yes	No	No	No
FAIL POINTS	No inherent fail points	Overheating of pellets (heating element)	No inherent fail points	Wiring assemblies
INITIAL INVESTMENT COST	\$\$	\$\$\$\$	\$\$	\$\$-
REPLACEMENT MAINTENANCE COSTS	\$	\$\$\$\$	\$\$\$	\$\$+
FIELD PERFORMANCE	✓✓✓✓	✓✓	✓✓+	✓✓
FRESHNESS	✓✓✓✓	✓✓-	✓✓	✓✓

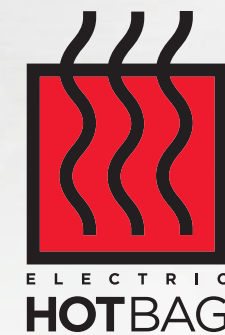

Designed and Assembled in the USA

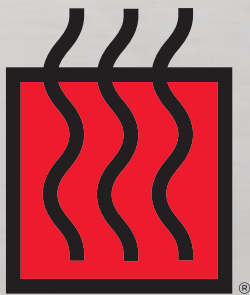

ELECTRIC<sup>®</sup>  
**HOTBAG**

**Hot and fresh delivery made simple.**

[hotbag.com](http://hotbag.com)

Made by Check Technology Solutions, USA